

# Engineering Specification

Job Name _____	Contractor _____
Job Location _____	Approval _____
Engineer _____	Contractor's P.O. No. _____
Approval _____	Representative _____
Tag _____	

## BFD-570

### HygienicPro® Processing Drain with 12" Round Top, Bottom Outlet

#### Specification

BLÜCHER HygienicPro® BFD-570 AISI Type 304 stainless steel processing drain with smooth interior, 12" round top, AISI 304 stainless steel CF-8 cast grating, and bottom outlet.



BFD-570

#### Dimensions

Model No.	EDP	H	Pipe Size D
BFD-574L	755.513.110	10 15/16"(277)	4"(110)
BFD-574M	755.503.110	14 7/8"(378)	4"(110)
BFD-574H	755.573.110	17 15/16"(455)	4"(110)
BFD-576L	755.513.160	7 15/16"(202)	6"(160)
BFD-576M	755.503.160	11 15/16"(303)	6"(160)
BFD-576H	755.573.160	14 15/16"(380)	6"(160)

Suffix	Options Description	
-316	Type 316 Stainless Steel	<input type="checkbox"/>
-B	Sediment Basket	<input type="checkbox"/>
-TPT	Trap Primer Tapping	<input type="checkbox"/>
-WT	Water Trap	<input type="checkbox"/>

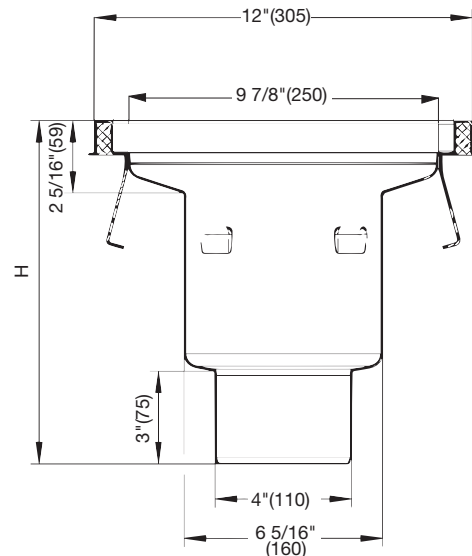

#### Approvals



Compliance with NSF/ANSI/3-A 14159-1-Hygiene Requirements for the Design of Meat and Poultry Processing Equipment



\* Product is certified to the uniform plumbing code ASME A112.6.3

#### NOTICE

The information contained herein is not intended to replace the full product installation and safety information available or the experience of a trained product installer. You are required to thoroughly read all installation instructions and product safety information before beginning the installation of this product.



**A WATTS Brand**

**USA:** T: (800) 338-2581 • F: (828) 248-3929 • BLUCHERpipe.com  
**Canada:** T: (888) 208-8927 • F: (905) 481-2316 • BLUCHERpipe.com  
**Latin America:** T: (52) 55-4122-0138 • BLUCHERpipe.com