

Engineering Specification

Job Name _____ Contractor _____

Job Location _____ Approval _____

Engineer _____ Contractor's P.O. No. _____

Approval _____ Representative _____

Tag _____

B-TP Tees

Specification

BLÜCHER PIPE AISI Type 316L (standard) stainless steel pipe system, with Push-Fit socket connections with EPDM (standard) sealing ring. All BLÜCHER PIPE to be treated with pickling and passivation finish process.

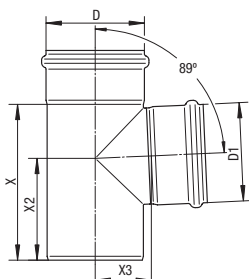

90° Tee Dimensional Chart

Model No.	D	D1	X	X2	X3
T1.5x1.5-90-316	1.5"(40)	1.5"(40)	4"(101)	2-3/4"(69)	1-3/16"(30)
T2x1.5-90-316	2"(50)	1.5"(40)	4-3/16"(106)	2-13/16"(71)	1-3/8"(35)
T2x2-90-316	2"(50)	2"(50)	4"(101)	2-13/16"(71)	1-1/4"(31)
T3x2-90-316	3"(75)	2"(50)	5-5/16"(134)	3-7/8"(98)	1-3/4"(44)
T4x2-90-316	4"(110)	2"(50)	5"(127)	3-11/16"(93)	2-7/16"(61)
T3x3-90-316	3"(75)	3"(75)	5-5/16"(134)	3-9/16"(90)	1-7/8"(47)
T4x3-90-316	4"(110)	3"(75)	5-13/16"(147)	4-1/8"(104)	2-9/16"(65)
T4x4-90-316	4"(110)	4"(110)	7"(178)	4-5/8"(117)	2-9/16"(64)
T6x4-90-316	6"(160)	4"(110)	9-1/16"(230)	6"(152)	3-1/2"(88)
T6x6-90-316	6"(160)	6"(160)	11-1/8"(282)	7-1/4"(184)	3-7/8"(98)
T8x6-90-316	8"(200)	6"(160)	11-1/4"(285)	7-5/16"(186)	4-5/8"(116)
T8x8-90-316	8"(200)	8"(200)	12-13/16"(325)	8-1/8"(206)	4-3/4"(120)
T10x8-90-316	10"(250)	8"(200)	13-9/16"(344)	8-11/16"(220)	5-13/16"(147)
T10x10-90-316	10"(250)	10"(250)	15-11/16"(399)	9-5/8"(245)	5-11/16"(144)

Global Ref. # 830.XXX.XXXS

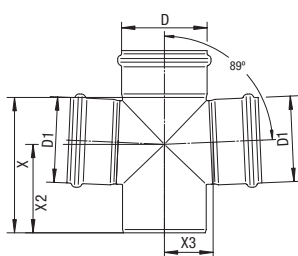

90° Double Tee (Cross) Dimensional Chart

Model No.	D	D1	X	X2	X3
C2x2-90-316	2"(50)	2"(50)	4"(101)	2-13/16"(71)	1-1/4"(31)
C3x2-90-316	3"(75)	2"(50)	5-5/16"(134)	3-7/8"(98)	1-3/4"(44)
C4x2-90-316	4"(110)	2"(50)	5"(127)	3-11/16"(93)	2-7/16"(61)
C3x3-90-316	3"(75)	3"(75)	5-5/16"(134)	3-9/16"(90)	1-7/8"(47)
C4x3-90-316	4"(110)	3"(75)	5-13/16"(147)	4-1/8"(104)	2-9/16"(64)
C4x4-90-316	4"(110)	4"(110)	7"(178)	4-5/8"(117)	2-9/16"(64)
C6x4-90-316	6"(160)	4"(110)	9-1/16"(230)	6"(152)	3-1/2"(88)
C6x6-90-316	6"(160)	6"(160)	11-1/8"(282)	7-1/4"(184)	3-7/8"(98)

Global Ref. # 831.XXX.XXXS

NOTICE

The information contained herein is not intended to replace the full product installation and safety information available or the experience of a trained product installer. You are required to thoroughly read all installation instructions and product safety information before beginning the installation of this product.

Watts product specifications in U.S. customary units and metric are approximate and are provided for reference only. For precise measurements, please contact Watts Technical Service. Watts reserves the right to change or modify product design, construction, specifications, or materials without prior notice and without incurring any obligation to make such changes and modifications on Watts products previously or subsequently sold.

Approvals



Compliance with NSF/ANSI/3-A 14159-1-Hygiene Requirements for the Design of Meat and Poultry Processing Equipment



Product is certified to the uniform plumbing code ASME A112.6.3



A WATTS Brand



90° Double Tee (90° Offset) Dimensional Chart

Model No.	D	D1	X	X2	X3
DT2x2-90-316	2"(50)	2"(50)	4"(101)	2 ⁻¹³ / ₁₆ "(71)	1 ⁻¹ / ₄ "(31)
DT3x2-90-316	3"(75)	2"(50)	5 ⁻⁵ / ₁₆ "(134)	3 ⁻⁷ / ₈ "(98)	1 ⁻³ / ₄ "(44)
DT4x2-90-316	4"(110)	2"(50)	5"(127)	3 ⁻¹³ / ₁₆ "(93)	2 ⁻⁷ / ₁₆ "(61)
DT3x3-90-316	3"(75)	3"(75)	5 ⁻⁵ / ₁₆ "(134)	3 ⁻⁹ / ₁₆ "(90)	1 ⁻⁷ / ₈ "(47)
DT4x3-90-316	4"(110)	3"(75)	5 ⁻¹³ / ₁₆ "(147)	4 ⁻¹ / ₈ "(104)	2 ⁻⁹ / ₁₆ "(64)
DT4x4-90-316	4"(110)	4"(110)	7"(178)	4 ⁻⁷ / ₁₆ "(117)	2 ⁻⁹ / ₁₆ "(64)
DT6x4-90-316	6"(160)	4"(110)	9 ⁻¹ / ₁₆ "(230)	6"(152)	3 ⁻¹ / ₂ "(88)
DT6x6-90-316	6"(160)	6"(160)	11 ⁻¹ / ₈ "(282)	7 ⁻¹ / ₄ "(184)	3 ⁻⁷ / ₈ "(98)

Global Ref. # 832.XXX.XXXX

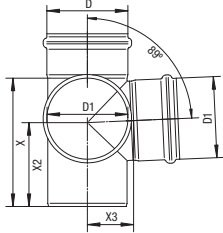

90° Degree Sanitary Sweep Tee Dimensional Chart

Model No.	D	D1	X1	X2	X3	X4
SS2x2-90-316	2"(50)	2"(50)	6 ⁻¹¹ / ₁₆ "(170)	2 ⁻³ / ₈ "(60)	3 ⁻³ / ₁₆ "(81)	1 ⁻¹³ / ₁₆ "(46)
SS3x2-90-316	3"(75)	2"(50)	7 ⁻⁷ / ₈ "(199)	2 ⁻¹ / ₄ "(57)	3 ⁻¹¹ / ₁₆ "(94)	2 ⁻⁷ / ₁₆ "(62)
SS4x2-90-316	4"(110)	2"(50)	8 ⁻¹ / ₄ "(209)	1 ⁻¹³ / ₁₆ "(47)	4 ⁻¹ / ₁₆ "(103)	3 ⁻¹ / ₈ "(80)
SS3x3-90-316	3"(75)	3"(75)	9"(229)	2 ⁻¹⁵ / ₁₆ "(75)	5"(127)	3 ⁻³ / ₈ "(86)
SS4x3-90-316	4"(110)	3"(75)	9 ⁻³ / ₈ "(239)	2 ⁻¹ / ₄ "(58)	4 ⁻¹ / ₂ "(115)	3 ⁻³ / ₈ "(86)
SS4x4-90-316	4"(110)	4"(110)	11 ⁻⁷ / ₁₆ "(290)	3 ⁻¹ / ₂ "(88)	5 ⁻⁷ / ₁₆ "(138)	3 ⁻³ / ₈ "(86)
SS6x4-90-316	6"(160)	4"(110)	12 ⁻¹ / ₁₆ "(306)	3 ⁻⁵ / ₁₆ "(84)	6 ⁻⁷ / ₁₆ "(164)	4 ⁻¹ / ₂ "(115)
SS6x6-90-316	6"(160)	6"(160)	14 ⁻⁵ / ₁₆ "(363)	4 ⁻¹ / ₂ "(115)	7 ⁻¹ / ₄ "(184)	4 ⁻¹³ / ₁₆ "(122)

Global Ref. # 848.XXX.XXXX

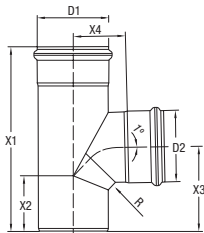

90° Degree Threaded Sanitary Sweep Tee Dimensional Chart

Model No.	D	D1	X1	X2	X3
848.050.050 W 2" NPT	2"(50)	2" NPT	6 ⁻¹¹ / ₁₆ "(170)	2 ⁻³ / ₈ "(60)	3 ⁻¹ / ₂ "(90)
848.075.075 W 3" NPT	3"(75)	3" NPT	9"(229)	2 ⁻¹⁵ / ₁₆ "(75)	5"(127)
848.110.110 W 4" NPT	4"(110)	4" NPT	11 ⁻⁷ / ₁₆ "(290)	3 ⁻¹ / ₂ "(88)	5 ⁻⁷ / ₈ "(150)

Global Ref. # 899-XXXXX-XX S

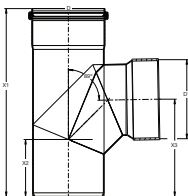

90° Degree Threaded Straight Tee Dimensional Chart

Model No.	D	D1	X1	X2	X3
830.050.050 W 2" NPT	2"(50)	2" NPT	5 ⁻¹³ / ₁₆ "(148)	4 ⁻³ / ₁₆ "(106)	1 ⁻³ / ₄ "(45)
830.050.075 W 2" NPT	3"(75)	2" NPT	7 ⁻⁷ / ₁₆ "(189)	5 ⁻¹ / ₂ "(139)	2 ⁻¹ / ₄ "(57)
830.110.110 W 4" NPT	4"(110)	4" NPT	9 ⁻⁷ / ₁₆ "(240)	7 ⁻¹ / ₄ "(183)	3 ⁻⁵ / ₁₆ "(85)
830.110.160 W 4" NPT	6"(160)	4" NPT	12"(306)	9 ⁻¹ / ₄ "(234)	4 ⁻⁹ / ₁₆ "(116)
830.110.200 W 4" NPT	8"(200)	4" NPT	13 ⁻⁵ / ₁₆ "(338)	9 ⁻³ / ₄ "(248)	4 ⁻⁷ / ₈ "(124)
830.110.250 W 4" NPT	10"(200)	4" NPT	14 ⁻⁷ / ₁₆ "(367)	10 ⁻³ / ₁₆ "(259)	5 ⁻⁷ / ₈ "(149)
830.110.315 W 4" NPT	12"(315)	4" NPT	16 ⁻¹ / ₈ "(410)	11 ⁻⁹ / ₁₆ "(294)	7 ⁻¹ / ₄ "(185)

Global Ref. # 899-XXXXX-XX S

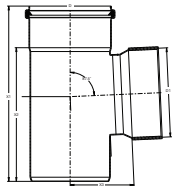

A WATTS Brand

USA: T: (800) 338-2581 • F: (828) 248-3929 • Watts.com
 Canada: T: (888) 208-8927 • F: (905) 481-2316 • Watts.ca
 Latin America: T: (52) 55-4122-0138 • Watts.com